



# Residents fear Denman Drive development

In one of the most significant development projects on the Suburb for forty years Freshwater has applied to The Trust and Barnet to pull down the garages in Denman Drive to make way for four two-bedroomed cottages and four one-bed flats. The entrance archway and flats would be retained but refurbished.

The site has been used as a garage and car repair shop for many years, first as R&B Motors, whose owners lived in Denman Drive, and for the past 20 years as Denman Drive Garages. It is indicative of the old world, neighbourly way the business has been run that R&B Motors is still the name on the board in Denman Drive and that the phone number is still shown as MEA 5057.

Terry Scales, who took over the business 20 years ago, says: "All my customers are local. I have never advertised and we get new customers entirely by

recommendation. It is the last small service business on the Suburb and I should think we will be missed."

The garages, which back on to Bigwood and the Chatham Close allotments, are in a very bad state of repair although work on them has several times over the years been said to be about to commence.

Mr Scales has been unable ever to get a lease completed, despite many attempts.

## Residents' worries

Surrounding residents are very concerned about a number of aspects such as the height of the proposed building, the potential loss of trees, about any possibility of part of the allotments being used for the new residents and about possible damage to Bigwood, newly a Local Nature Reserve, and the, probably Saxon, embankment which borders Bigwood and runs alongside the site through to Little Wood and marks the boundary between the ancient estates belonging to St Pauls and Westminster on part of which the Suburb was built.

Freshwaters have arranged a public meeting and exhibition of the plans which will take place on April 27 at Fellowship House, Willfield Green at 8pm.

RICHARD WAKEFIELD

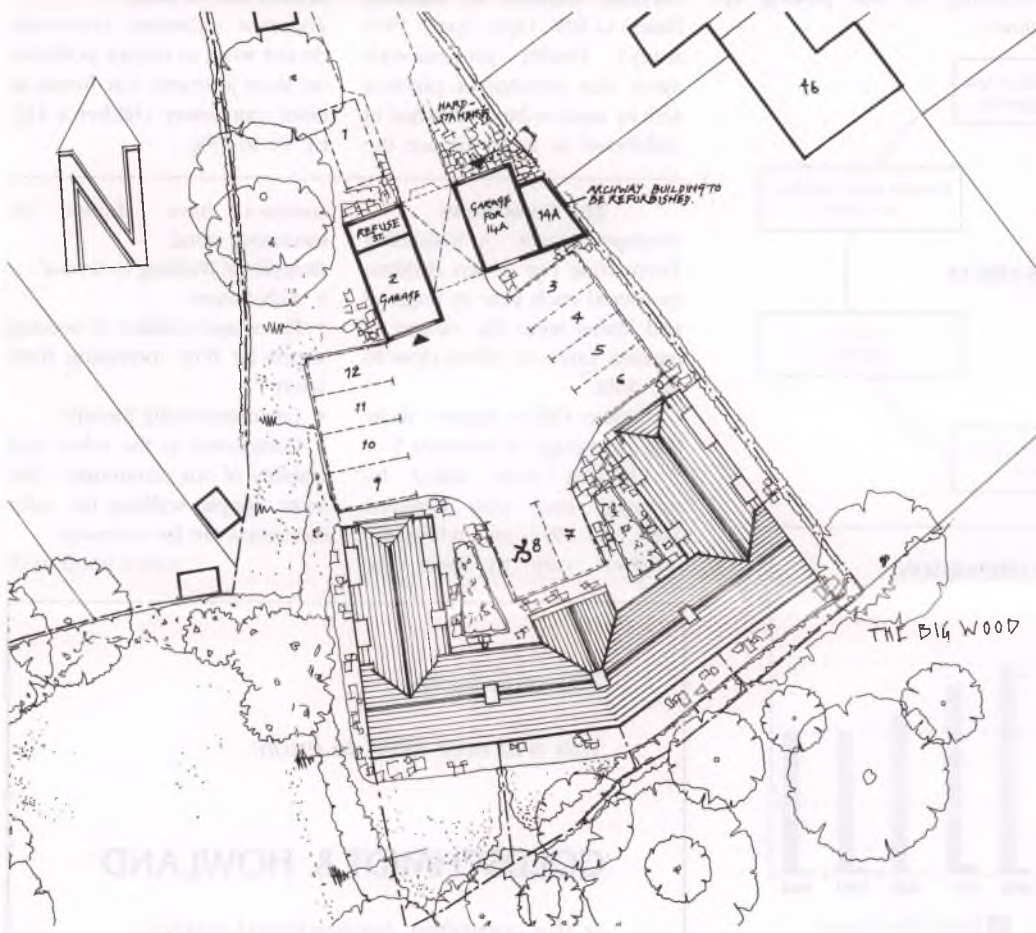

## We need your help

Are you interested in keeping the Suburb beautiful? We are looking for a few new members for *Consam*, the Conservation and Amenities Committee of the Residents Association.

*Consam* works to help ensure the protection and enhancement of the appearance, character and tradition of Hampstead Garden Suburb and its amenities.

*Consam's* work for the conservation and improvement of our unique environment includes the scrutiny and discussion of planning proposals with the HGS Trust and Barnet

Council where appropriate. We are also involved in attempting to stem the tide of street clutter which is currently threatening the Suburb.

If you live on the 'North Side', have experience of negotiating with a local authority (not necessarily Barnet) or are an architect, you'd be especially welcome. Meetings are generally held once a month on the second Monday in the evening.

If you would like to join *Consam*, please phone David Lewis 0181 731 9039 (evening) or 0171 433 1121 (day).

## Artists international sales

Pictures of the Suburb are a firm favourite with people who live among us for a while and then return to other parts, and several Gallery artists can claim that their pictures hang in international collections. The latest is Christine Barrow, as two of her watercolours of Suburb doorways returned to Cleveland last month with Anne Schoff who had been staying with relatives in Hampstead Way. Anne said she had really enjoyed her afternoon in your lovely little gallery!

Many will remember the Gunstensens who lived in Heath Close. Sheila said that her collection of Annie Walker pictures would be a permanent reminder to her children of the beautiful area where they had spent so



Gerard Mansell, Still life

much of their childhood. That collection is now in Connecticut.

The Reids who returned to the States last year from

Litchfield Way went one better and persuaded Annie to include their three children in their house portrait and even to include a red post-box that wasn't there!

The Gallery is planning a one man show of the works of Gerard Mansell who has been chairman of both the Residents Association and the Trust.

Gerrard, whose distinguished career at the BBC was preceded by attendance at the Slade, paints still lifes and landscapes in his beloved France.

## 90th anniversary?

The Institute is 90 this year. Suburb residents who are also 90 are invited to celebrate with

us. Call Nancy Traeger any Wednesday, Thursday or Friday morning on 457 5103.

## BRILL ■ OWEN CHARTERED ARCHITECTS

For a sensitive and sympathetic approach to Architecture and Interior design we offer a full or partial service to suit your requirements.

NICHOLAS BRILL M.SC. DIP. ARCH. RIBA MBIM  
ASSISTANT TRUST ARCHITECT 1987-88

42 NEW OXFORD STREET • BLOOMSBURY  
LONDON WC1A 1EP • TELEPHONE 0171 580 5747  
FAX 0171 580 5626

## Henrietta Barnett school - clarifying the issues

Jane de Swiet, headteacher at Henrietta Barnett points out that our lead article in the Winter 99 Issue 62 about the Henrietta Barnett School and the Grammar School ballot procedures was misleading in some respects and makes the following points:

- If a ballot is instigated, there will be one ballot determining the ethos of all three schools together. No school's future can be regarded separately from the others.
- There is a Code of Practice issued by DFEE, which applies to all interested parties either campaigning for or against the ballot. The Code applies to material provided to parents irrespective of when and where

it came from or the motives of the author.

- If there is a change in admissions, there can never be an automatic right to admission to a school. Parents have the right to express a choice and to expect that it is treated with full respect but it does not guarantee a place.
- Many of our staff have taught in comprehensive schools and many leave to take up positions in them; they all agree that teaching is very different at The Henrietta Barnett School, relatively free of discipline problems but very demanding intellectually, and a very heavy marking and preparation load. Very rewarding but not easy.

## A MILLENNIUM SUNDIAL

Based on the 0 degree Longitude and 51 degree 30 minutes Latitude of Greenwich Observatory, this horizontal sundial, designed by a local Architect as a permanent memento to 2000, is cast in bronze and hand finished by Craftsmen.

Designed for the garden, it is available at the Suburb Gallery in Hampstead Way or from Sundial 2000 limited at £195 including VAT and carriage within the UK mainland but excluding North Scotland.

A base to take the sundial, in reconstituted bath stone, 85cm high and with a 44cm diameter platform is available at £150, ex works, direct from Sundial 2000 limited.  
Carriage is likely to be £45.

## Sundial 2000 limited

PO Box 20336  
London NW11 6ZD  
Telephone 0181 731 7511. Fax 0181 731 7512